

- {29} ABOUT THE ISSUE
- {30} REFLECTIONS
- {32} UPDATES
- {40} Architecture+Design & Spectrum  
Foundation Architecture Awards  
2010 Announcement

**ESSAY**

- {44} Bio Mimicry in Architecture...  
*Palash Deolankar, Dr P S Chani,  
Dr Partha Roy*

**PROFILE: HKS, INC. Dallas**

- {52} • Architecture in India Going Green  
*Gaurang Sheth*
- {56} • Extending Structural Boundaries  
Cowboys Stadium, Texas
- {68} • Reflecting Venetian Streetscape  
The Venetian Macau Resort-Hotel-  
Casino, Macau
- {74} • Creating a Healing Environment  
Salem Hospital Patient Care Tower,  
Oregon

**PROJECT FEATURE**

- {82} A New Rail Terminal  
Anand Vihar Terminal, New Delhi  
*Rites Ltd, Gurgaon*

**URBANISM**

- {90} • Art in Multi Modal Transport System  
for Delhi  
*Pawan Kumar*
- {98} • How can We Plan our Cities Better?  
*Gurpreet Singh*

**OFFICE INTERIORS**

- {104} • Inducing Vibrancy  
NOCC, Gurgaon  
*Spaces Architects, New Delhi*

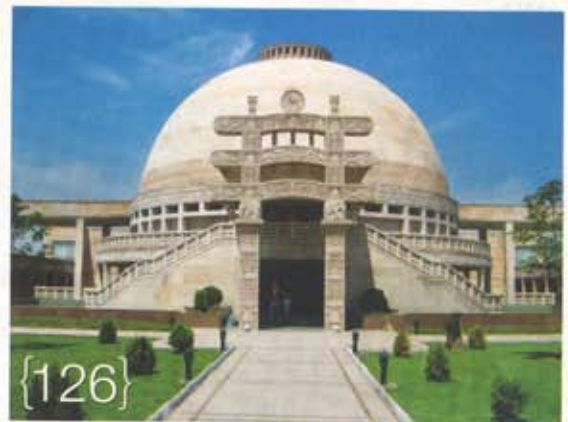
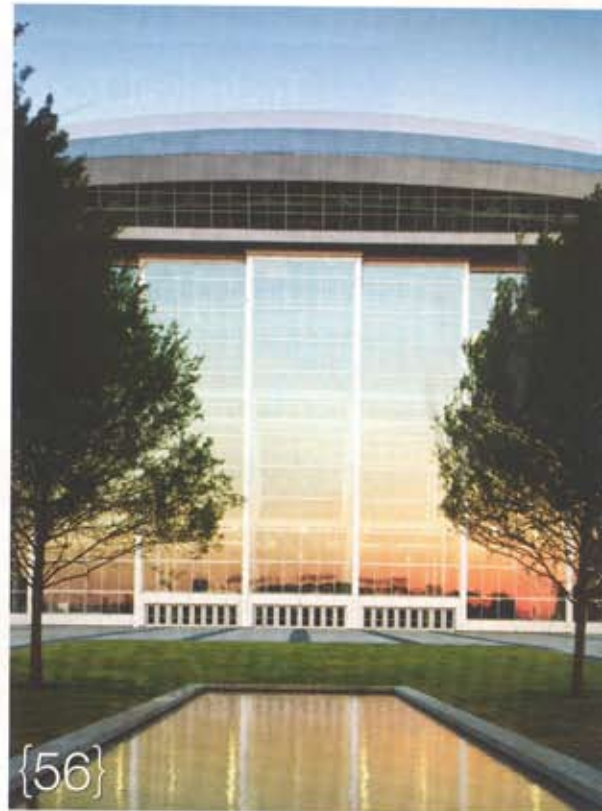

Salem Hospital Patient Care  
Tower, Oregon  
(Architects: HKS, INC.)

- {114} • Rejuvenating a Studio  
*UCJ Architecture & Environment  
Studio, Mumbai*
- {120} • Industrial Expressions...  
*Padmini VNA Mechatronics  
Corporate Office, Gurgaon  
Pitamber Sahni Design Studio,  
New Delhi*

**INTERNATIONAL PROJECT FEATURE**

- {126} • Blending Modern Construction  
Techniques...  
*Indian Style Buddhist Temple, China  
AJRC, New Delhi*

**PHOTO FEATURE**

- {136} Old World Charm - Penang  
*Rupa Gopal*

**BOOK REVIEW**

- {140} Architecture of a Royal Camp –  
The Retrieved Fort of Nagaur  
*Reviewed by Deependra Prashad*

# Inducing vibrancy



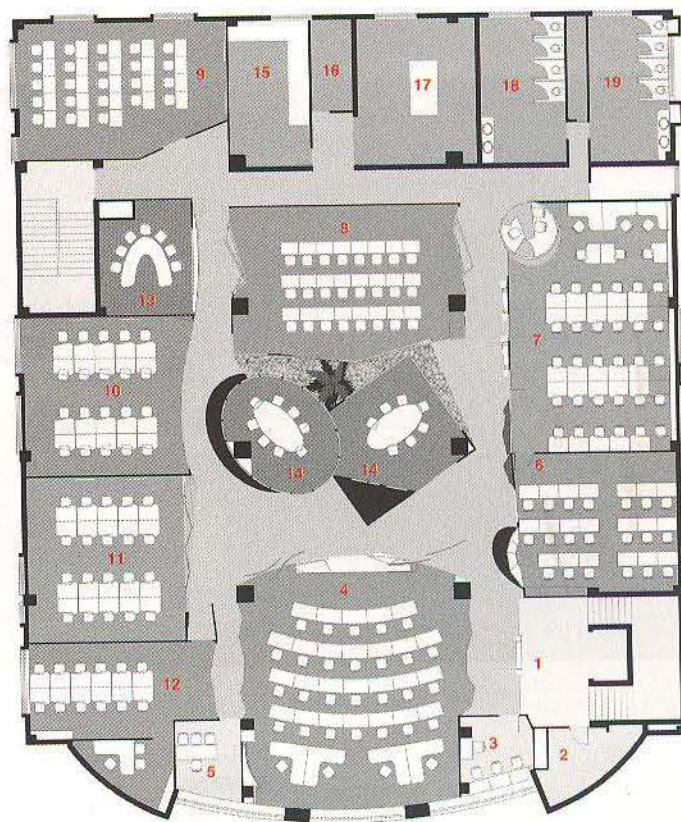

#### LAYOUT PLAN

- |                 |                  |                     |
|-----------------|------------------|---------------------|
| 1. ENTRANCE     | 8. NOCC-2        | 15. HUB ROOM        |
| 2. LOCKER ROOM  | 9. NOCC-3        | 16. ELECTRICAL ROOM |
| 3. CONTROL ROOM | 10. NOCC-4       | 17. A H U           |
| 4. MAIN STUDIO  | 11. OFFICE-2     | 18. GEMT'S ROOM     |
| 5. CABIN        | 12. NOCC-5       | 19. LADIES TOILET   |
| 6. NOCC-1       | 13. V C ROOM     |                     |
| 7. OFFICE-1     | 14. MEETING ROOM |                     |



The client's brief on this interior was to have a space with creative approach in office space and an open office with big glass panels and have a very youthful and vibrant ambience. The whole area has been designed keeping in harmony rhythm and transparency between different spaces. Everything that has been designed falls in a perfect frame, as one sees in a direction from a particular position and the same frame changes to another frame by changing one's position.

The concept has been derived using abstract shapes, panels, forms and use of pastel shades. It's a spatial experience which one discovers as walking through the corridor. An attempt has been made to create multiple views beyond partitions and connecting the whole area to give an open office environment.



The office interior of 10,000sq ft has a main studio of 30 seats with multiple NOCC rooms. Two office areas which are supporting NOCC are placed on either side. The main studio has ascending stepped platform in curved form reflected on the ceiling. The glasses of the open studio are in inclined abstract shape placed along the side. The abstract curved partition at the front defines physically the space and also connects visually to the office space.

The geometric and abstract forms with use of pastel colour define the space. Egg-shaped meeting room intersect with rectangular meeting room placed at 45° angle. The elliptical meeting room has a bright green pastel shade contrasting with dark teak cladding on square meeting room. The front of the rectangular meeting room has been laminated with a mirror effect laminate with the circles having transparent glasses. This creates illusion when one proceeds from the entrance towards the meeting room. The design has been achieved by various stages of development. The ceiling outside the rectangular meeting room is projected outside with backlit acrylic sheet. The same impression is given on floors by using dark coloured tiles which gives the feel of the shadow of the ceiling. This dark coloured tile is also used to create transitional spaces throughout.

The NOCC-1 has brown painted multiple panels projecting outside, which create an interesting element. The pyramidal glass, tapering upwards gives a nice view of the NOCC-1 near the entrance and connects the whole space. The Office-2 has blue paint with abstract cut frosted glass, backlit. It has vertical glasses placed at angles. The NOCC-4 has front partition in curved shape which continues on the top of the Video Conference Hall. It has rectangular windows at different heights. The Video





CORRIDOR ELEVATION (Office-2)



CORRIDOR ELEVATION (NOCC-1)



MEETING ROOM ELEVATION



MAIN STUDIO STORAGE ELEVATION





### Contextual Reference & Environmental Concerns

- » The site has glazed windows from three sides with low emission glasses.
- » The main studio is placed in the north side as it consumes maximum HVAC load.
- » A number of eco-friendly materials have been used: Recyclable nylon based carpets; MDF boards which is also recyclable; Maximum reflective surfaces; engineered wooden tiles instead of natural wooden flooring.
- » Gloss duco paint is used on partitions which allow maximum reflections from surfaces.
- » Energy-efficient equipments (LCDs, copiers, printers, etc) have been used with star rated technology which reduces energy consumption.
- » Direct and indirect lights are used wherever required to reduce the glare of the light.
- » Water usage has been reduced by 30% by using waterless urinals and low flow faucets and WCs.

Conference Hall has glasses of different sizes painted in dark pink colour.

The abstract partition in NOCC-2 has been designed at inclined angles in both the axis with glasses taking the same shape as of inclined partitions. The glass window and view panels have abstract shapes and extensive glass which is used to enhance transparency to the interior. The interior space has been perceived as an art form with free flowing spaces, elements, their relationships and response to humans. A frame with elements forms a different canvas viewed from different directions. It's an experiment to connect floor, wall and ceiling.

The studio furniture has all the tables in curved form. Each table has different cladding with multiple sizes of different shades of mica highlighted by cove lighting. The storage cabinet at the front in the studio takes a curve from front and has abstract brown duco painted panels constructed from front to top and side which act as screen and disable the movement from front.





View of the storage with the ceiling panel in the main studio of NOCC, Gurgaon



The green area in between the meeting rooms and NOCC-2 adds life to the whole visual space. The open duct is round and painted in silver matt colour to give it a factory

look. All the columns are treated in a different way. The column in the main studio is clad with veneer and ceramic glass at different levels. The column in the elliptical meeting room has cement tiles and NOCC-2 has cement tiles with ceramic glass.

The spaces turn into dramatic and magical environment at places, creating illusions. One discovers new forms and relationship with the surroundings. There are multiple experiences viewed from different spaces. ✚

*Photo credit: Akhil Bakshi*



#### **FactFile**

**Client:** NIIT Technologies Ltd | **Design team:** Kapil Aggarwal (Principal Architects), Nikhil Kant, Ankita Sweety, Anand Lal | **Contractor:** IDI Pvt Ltd (Interior) | **Consultants:** Airoon Ltd (AC) | **Area:** 10000sq ft | **Cost of project:** Rs 1,20,00,000 | **Year of completion:** 2009